

GasGuard GG10

Series
Nozzle

The GG10 Gasguard nozzle, fitted with a 1 3/4" Acme thread connection, is used for filling small to medium LPGas storage facilities.



• World Wide Distribution



The GG10 Gasguard nozzle has been designed to fit to hose reels for dispensing bulk LPGas to small / medium tank and industrial storage facilities. The nozzle is robust and exhibits a high level of operator safety.

Covered by Australian Patent N. 265897. Other Australian and International Patents.

Standard Features

- The nozzle will not open to atmosphere when actuated in an uncoupled state. Even when fitted with a Gasguard LG11 or M570 Back Check Valve.
- The Valve shut down mechanism uses a Piston Dashpot which minimises the line shock spike.
- The GG10 nozzle has an extra 40mm reach than competitor nozzles, yet does not compromise the operating envelope.
- The GG10 nozzle has a twin seal / Ball race Swivel fitted as standard. It comes in a 1" or 1 1/4" NPT female thread.
- The combined weight of the GG10, including the inlet swivel is 3.1kg.
- The GG10 operating envelope matches that of all competitors even when it has a longer reach capability.
- A heavily ribbed Connector makes gripping and rotation of this component easy for a gloved or non gloved hand.
- Internal dust and blow back seals prevent the ingress of dust and dirt to moving parts and stops product blow back on disconnect.
- Low temperature seals to -40 C are utilised throughout the nozzle.
- The design of components is as robust as possible without making the unit abnormally large.
- Product lost on disconnect is 7cc.

Dimensions

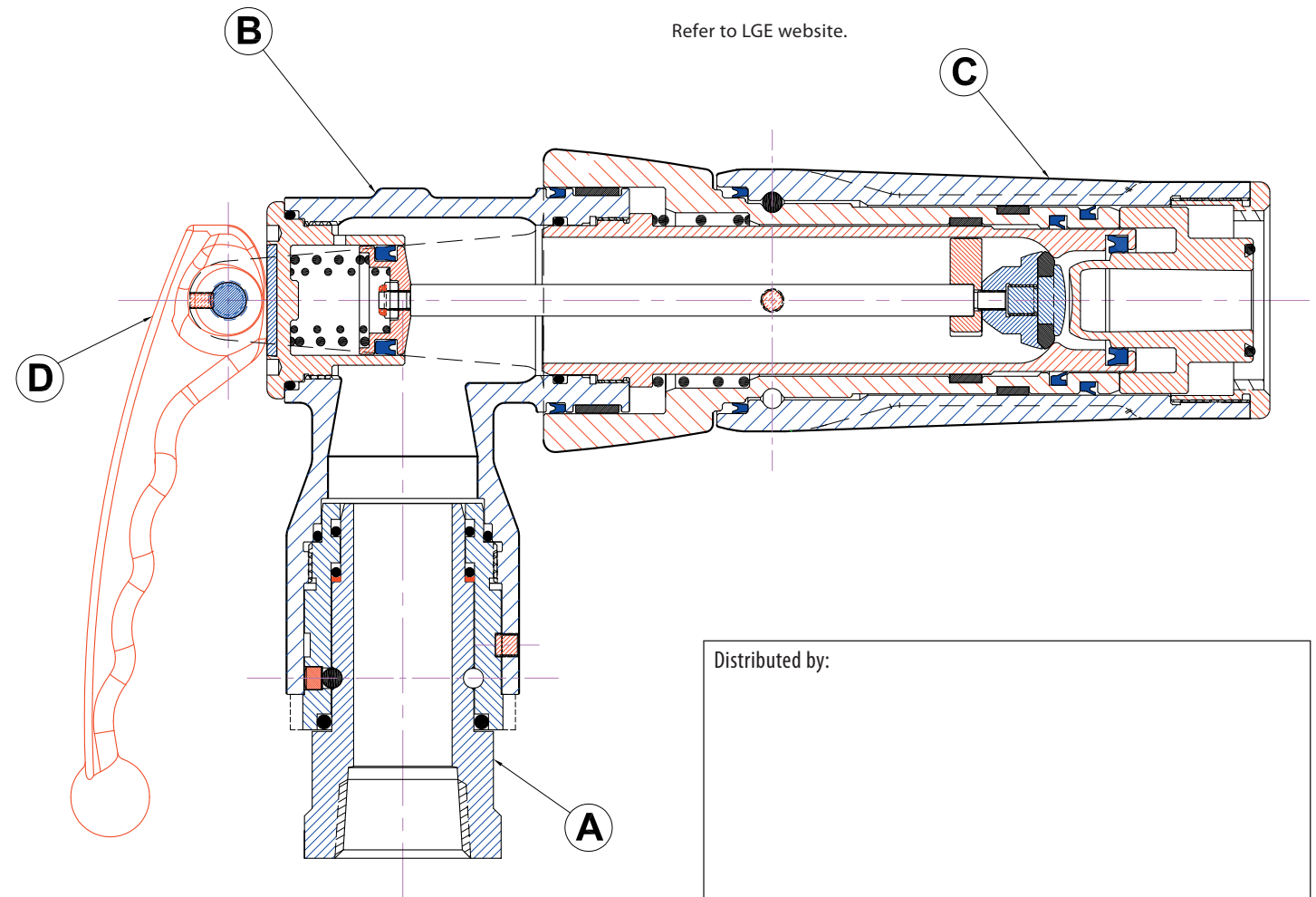

Specifications

1. Connection sytem..... 1 3/4" x 6 TPI Acme thread.
2. Inlet Swivel thread..... 1" or 1 π" NPT female thread.
3. Net weight 3.1 kg (6.6 lbs)
4. Max. Operating pressure..... 2450 kPa. (350 psi)
5. LPGas discharged on lever release 7 cc (nozzle only).
6. Body and Slide sleeve material Aluminium casting T6
7. Lever material and Nose assembly Hard anodised aluminium
8. Seal materials..... -40 to +115°C

Nozzle Sub-assemblies

Item	PART No.	DESCRIPTION	Req	Drawing	Options
A	GG102	GG10 Inlet Swivel Assembly	1	X1402	1" NPT or 1 1/4" NPT
B	GG104	GG10 ValveBody Assembly	1	X1404	Standard
C	GG107	GG10 Connector Assembly	1	X1407	Standard
D	GG105	GG10 Lever Assembly	1	X1405	Standard

Accessories

- Seal repair kit GG103 contains all seals, O rings and bearing for complete nozzle.
- Spare parts..... refer to SPPL – GG10 through your regional Distributor.

Refer to LGE website.

Distributed by:

The Gasguard GG10 Liquefied Petroleum Gas Nozzle is manufactured by:

L.G. Equipment Pty. Ltd. A.B.N. 70 003 275 250 Sydney N.S.W. Australia www.gasguard.com.au

A division of ELAFLEX HIBY Tanktechnik GmbH & Co



DISCLAIMER: Due to our policy of continual improvements in the design features, we reserve the right to alter the above specifications and design at any time without notice. The LG30 GasGuard Nozzle is a mechanical device which has a finite life, depending on environmental and operational conditions. Since it is handling hazardous flammable liquids, it is essential for continued satisfactory operation, that periodic inspection and maintenance be carried out by fully trained and experienced personnel adhering to International L.P.G. (propane) Industry safety procedures and standards.